

# Precision Linear Potentiometer DL30 V2

Standard version



The precision linear potentiometers type DL30 provide a 30 x 30mm aluminium housing and offer protection class IP60 in the standard version. Optionally protection class IP65 is possible. The smooth running is ensured by permaglide sliding bearings.



The standard version is supplied with 4 clamping claws.

### Mechanical Data

- 1.1 Housing..... : Aluminium
- 1.2 Pushrod..... : Stainless steel
- 1.3 Bearing..... : Permagliding sliding bearing
- 1.4 Resistor element..... : Precision wire winding
- 1.5 Slider / wiper tap..... : Noble metal, single
- 1.6 Protection class..... : IP 60
- 1.7 Type of connection..... : Cable connection, 3m
- 1.8 Mounting element..... : Clamping claws
- 1.9 Functional path..... : 30...500 mm
- 1.10 Adjusting speed..... : 1 m / sec.
- 1.11 Lifetime..... : 1 x 10<sup>6</sup> m path

### Options

- Short-circuit tracks
- Differing functional path
- Resistance tolerance: ±1%
- Linearity: min. 0,1%
- Pushrod: special length
- Protection class IP65
- Plug connection
- Oilfilling

### Accessories

- Adapter plate
- Extended connection cable
- Swivel head

### Other versions

- Integrated measuring transducer
- 0/4...20 mA or 0...10 VDC (housing length L1 = L1 + 50)
- Linear potentiometer with spring function

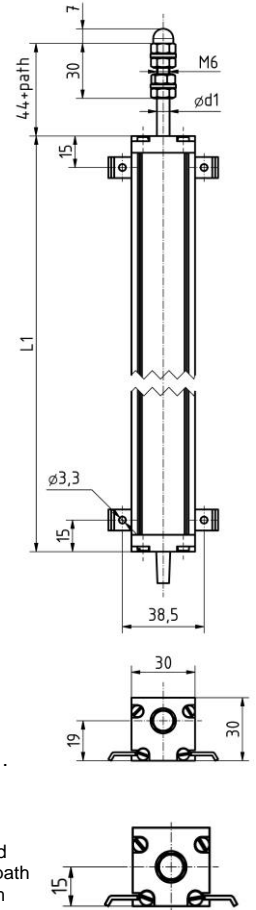

### Electrical Data

- 2.1 Resistance values, standard.... : 1, 2, 5, 10 K-Ohm
- 2.2 Max. resistance value..... : See table
- 2.3 Resistance tolerance..... : ± 3%
- 2.4 Min. starting resistance..... : 0,05% of total resistance
- 2.5 Linearity tolerance..... : ± 0,3%
- 2.6 Insulation Resistance..... : 20 M-Ohm
- 2.7 Test voltage..... : 500 V, 50 Hz
- 2.8 Operating voltage ..... : Max. 50 V
- 2.9 Total load..... : Max. 2 Watt
- 2.10 Slider load current..... : 1 mA (max. lifetime)
- 2.11 Temperature range..... : -50°C bis +100°C
- 2.12 Temperature coefficient..... : 20 ppm/°C

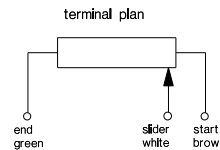

Type	path in mm			max KΩ	L1 in mm							
	electr. +0,8mm	mechan. ±3mm	Ø d1 in mm		cable	plug	cable Tfa	plug Tfa	cable Tfi	plug Tfi	cable Rfi	plug Rfi
DL30/ 30 V2	30	40	6	25	95	165	95	165				
DL30/ 50 V2	50	60	6	40	115	165	115	165	165	215	165	215
DL30/100 V2	100	110	6	80	165	215	165	215	215	265	215	265
DL30/150 V2	150	160	6	120	215	265	215	265	265	315	265	315
DL30/200 V2	200	210	6	160	265	315	265	315			315	365
DL30/250 V2	250	260	6	200	315	365	315	365			365	415

Paths in excess of 500mm only in sensor version (0/4...20 mA, 0...10 VDC).

\* At construction set calliper spring outside (Tfa) + nominal length ≥ 100mm, dimension 95mm + path

Option
Return spring inside (Rfi) DL30
Construction set calliper spring inside (Tfi) DL30
Construction set calliper spring outside (Tfa) DL30
Construction set plug DL30

### Scope of delivery includes

- Cap nut 1 pce 101577
- Hexagon nut 3 pcs 101578
- U-plate 2 pcs 101541
- Clamping claws 4 pcs 104642

Sheet #: KE3320.docx

Änderung / Druck: 22.07.20 / 22.07.20

### ALTMANN Potentiometer

Herringhauser Straße 29  
32051 Herford

Postfach 11 42  
32001 Herford

Telefon 05221/3404-0  
Telefax: 05221/3404-29

www.potentiometer.de  
eMail: [info@potentiometer.de](mailto:info@potentiometer.de)

Subject to technical  
amendments Form.#. Am04-10