

Mechanical Data

- 1.1 Housing.....: Reinforced glass fibre plastic
- 1.2 Shaft.....: Plastic $\varnothing 6$ (option metal reinforced)
- 1.3 Bearing.....: Sliding bearing
- 1.4 Resistance element.....: Conductive plastic
- 1.5 Slider tap / wiper tap.....: Multiple tap
- 1.6 Housing protection class.....: IP 65
- 1.7 Type of connection.....: Terminal wires 0,5mm²
- 1.8 Mounted by.....: Central fixing M10 x 0,75
- 1.9 Electrical rotation angle.....: 310°
- 1.10 Mechanical rotation angle.....: 320° -5°
- 1.11 Short circuit track: 2 x 5°
- 1.12 Rotation speed.....: Max. 500 rpm
- 1.13 Torque.....: 2,5 till max. 6,0 Ncm *1 (option 0,5 till 1,5 Ncm)
- 1.14 Rotation load life.....: 1 x 10⁶ slider path (360°)
- 1.15 End stop strength.....: 50 Ncm
- 1.16 Tensile strenght at shaft.....: 80 N

Electrical Data

- 2.1 Resistance values, standard.....: 10 K-Ohm
- 2.2 Resistance tolerance.....: $\pm 20\%$
- 2.3 Max. initial and final resistance.....: 50 Ohm
- 2.4 Linearity tolerance.....: $\pm 2\%$
- 2.5 Insulation resistance.....: 8 G-Ohm
- 2.6 Test voltage.....: 1,5 kV, 50 Hz
- 2.7 Operating voltage.....: Max. 50 V
- 2.8 Power rating.....: Max. 1 Watt
- 2.9 Slider load current.....: Max. 1 mA
- 2.10 Temperature range.....: -20°C till +100°C
- 2.11 Temperature coefficient.....: ± 500 ppm/°C

*1 Torque measured with mounted nut (tightening torque 40Ncm)

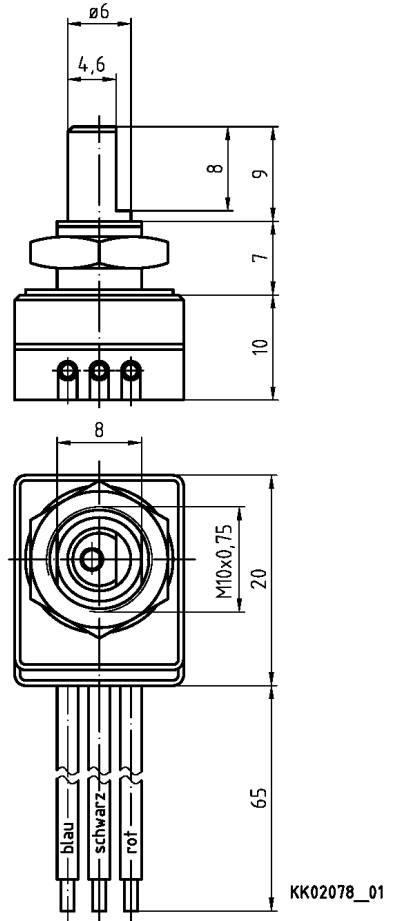

Insulation distance of 2mm to housing outside edge must be observed.

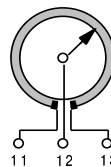
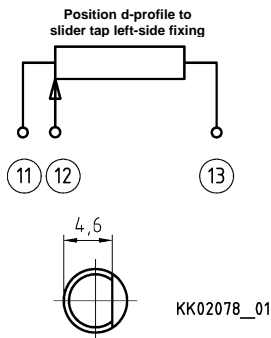

Terminal Plan

| point | function | colour |
|-------|----------|--------|
| 11 | winding | blue |
| 12 | slider | black |
| 13 | winding | red |

Scope of delivery includes:

Order #: 101594 1 piece hexagon nut M10x0,75 depth=2mm, SW14